

GLOBES AND MAPS

A **globe** is a model of the Earth.
It's a **sphere**.
It's got the same shape as the Earth.

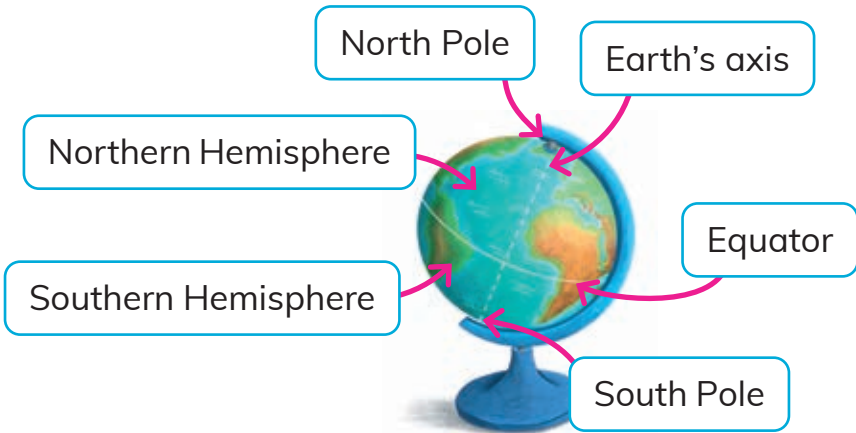

A **map** is a **flat** representation of the Earth.
World maps show continents and oceans.

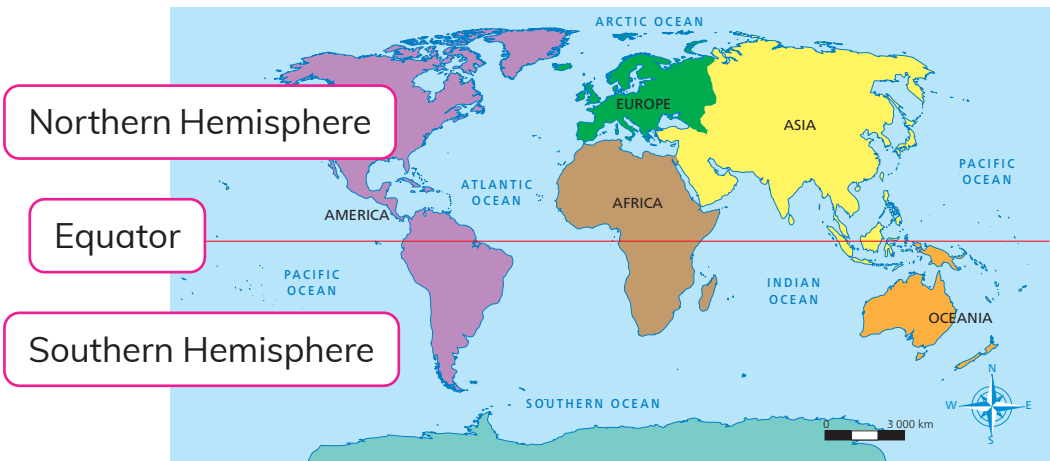

ELEMENTS ON A MAP

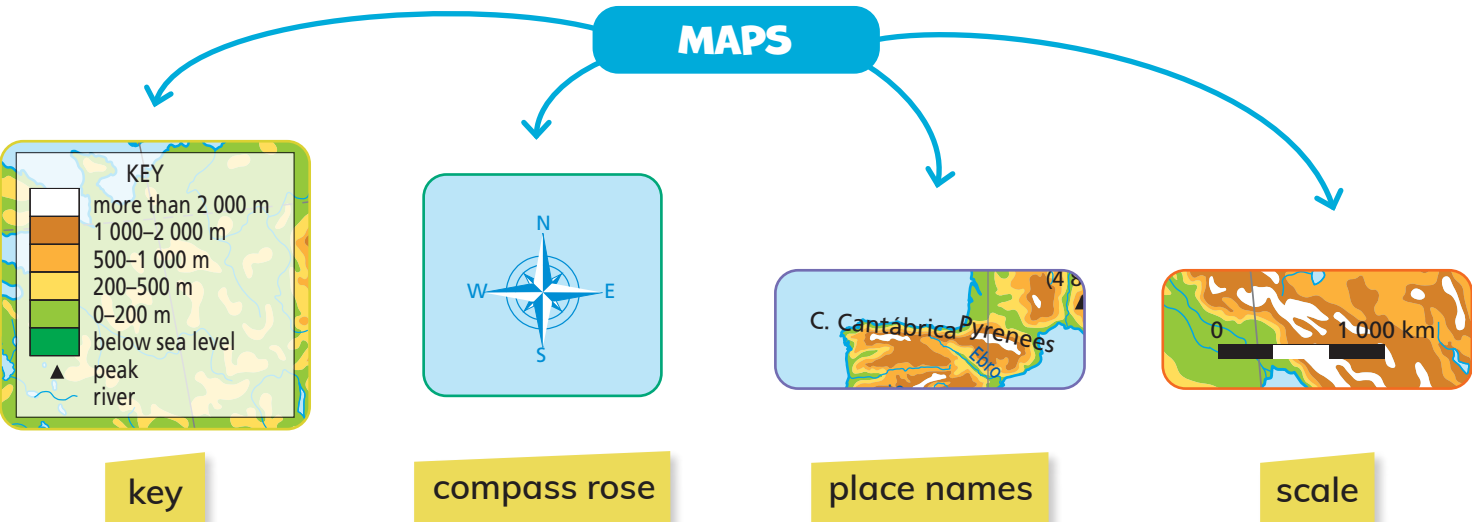

Maps with a **small scale** show very large areas. Maps with a **large scale** show smaller areas.

TYPES OF MAPS

There are different types of maps.

Political maps

They use colours to represent countries, regions and cities.



Physical maps

They use colours and symbols to represent landforms.



Thematic maps

They show different types of information, for example the weather.



STREET MAPS AND PLANS

Street maps

They show a village or a city. They've often got a grid and coordinates

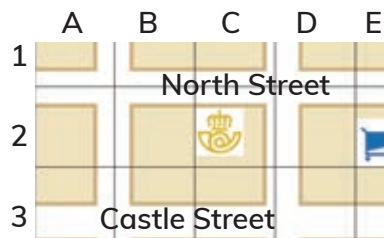

Plans

They show a building, house or room. They can show a lot of detail.

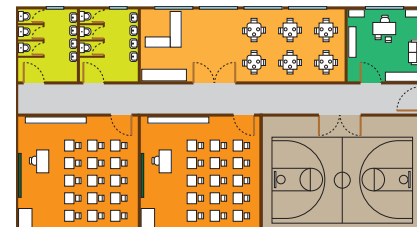

ORIENTATION

We can use a compass, the Sun and the stars to find our way.

A **compass** shows the cardinal points. The **needle** always points north.



The **Sun** always rises in the east.



The **Pole Star** is always in the north.

